



**GRIFFIN-SPALDING  
COUNTY AIRPORT**  
GRIFFIN, GEORGIA

**Michael Baker  
INTERNATIONAL**

Designer:  
**JCD, CPC**  
Technician:  
**CPC**  
Checked by:  
**JCD**  
Project Number:  
**143849**

PROPOSED INITIAL EASEMENT ACQUISITION									
PARCEL	GRANTOR	INTEREST	ACREAGE	CONVEYANCE	DATE	DEED BOOK	DEED PAGE	FAA GRANT #	PURPOSE
SEA-08	Brown, Terry E	EASEMENT	1.14						
SEA-09	Cooksey, Joseph T. & Elaine B.	EASEMENT	1.00						
SEA-18	Ridding, Gary Keith	EASEMENT	2.03						
SEA-07	Snelling, Jeffrey Drum et al c/o Cathy Snelling	EASEMENT	4.70						
SEA-12	Blocker & Rochester L.L.C.	EASEMENT	5.00						
SEA-13	Cecil, Samuel	EASEMENT	7.00						
SEA-17	Whaley, Dolle B	EASEMENT	25.00						
			<b>Total Acreage</b>	<b>45.87</b>					

PROPOSED ULTIMATE EASEMENT ACQUISITION									
PARCEL	GRANTOR	INTEREST	ACREAGE	CONVEYANCE	DATE	DEED BOOK	DEED PAGE	FAA GRANT #	PURPOSE
NWA-01	Lamar & Carolyn Jones	EASEMENT	0.70						
NWA-02	Arnold M Cobb	EASEMENT	3.62						
NWA-03	Lamar & Carolyn Jones	EASEMENT	1.46						
NWA-04	Robert M Seiber	EASEMENT	2.25						
NWA-06	Wills Properties LLLP	EASEMENT	33.38						
NWA-07	Wilson, Karen L. & Rose, Billy N	EASEMENT	4.77						
NWA-12	Wills Properties LLLP	EASEMENT	12.87						
NWA-13	Moore, Nancy D	EASEMENT	0.95						
NWA-14	Greer, Lela H	EASEMENT	5.00						
NWA-17	Scott, Martha P. - C/O James Randall Scott	EASEMENT	2.74						
NWA-18	Landers, W.L. & Betty S.	EASEMENT	2.78						
NWA-19	Scott, Judy V.	EASEMENT	1.09						
NWA-20	Edwards, James H. & Lois	EASEMENT	0.90						
NWA-21	Kennedy, Lillian E.	EASEMENT	0.98						
NWA-23	Sabti, Penny R	EASEMENT	1.40						
NWA-24	Phillips, Nina	EASEMENT	1.41						
NWA-25	196 Kennedy Road LLC	EASEMENT	1.41						
SEA-10	Banks, Vivian Denise	EASEMENT	1.00						
SEA-11	Benedict, Thomas M. & Kule G.	EASEMENT	1.00						
SEA-14	Johnson, Franklin Darnell & Norma Jean	EASEMENT	0.23						
NWA-08	Hopkins, Aka, Joycetalal	EASEMENT	36.00						
SEA-15	Merritt, William A. & Peggy	EASEMENT	5.00						
SEA-19	Raines, James et al c/o Regions Bank	EASEMENT	4.00						
			<b>Total Acreage</b>	<b>124.54</b>					

- NOTES**
- AERIAL PHOTO SOURCE: QUANTUM SPATIAL TAKEN OCTOBER 22, 2014
  - PARCEL MAP SOURCE: CITY OF GRIFFIN GIS DEPT.
  - ACREAGES LISTED ARE APPROXIMATE BASED ON COUNTY GIS AND COUNTY TAX MAP DATA. ACREAGES TO BE ADJUSTED BASED ON RESULTS FROM LAND SURVEYS TO BE PERFORMED BY OTHERS.

LEGEND	
DESCRIPTION	
PROPOSED INITIAL PROPERTY LINE	---
PROPOSED ULTIMATE PROPERTY LINE	---
PROPOSED INITIAL EASEMENT	---
PROPOSED ULTIMATE EASEMENT	---
PROPOSED PARCEL LINES	---
PROPOSED UTILITY CORRIDOR	---
ULTIMATE RSA	---
ULTIMATE ROFA	---
PROPOSED RPZ	---

REVISIONS			
No.	Description	Date	By

Project Name:  
**AIRPORT LAYOUT PLAN**

Drawing Name:  
**EXHIBIT "A"  
AIRPORT PROPERTY INVENTORY MAP**

AIP Project Number:

Autocad Drawing Reference:

Date:  
**AUGUST 2017**

Division:  
**PLANNING**

Scale:  
**1" = 600'**

Drawing Number:  
**18**

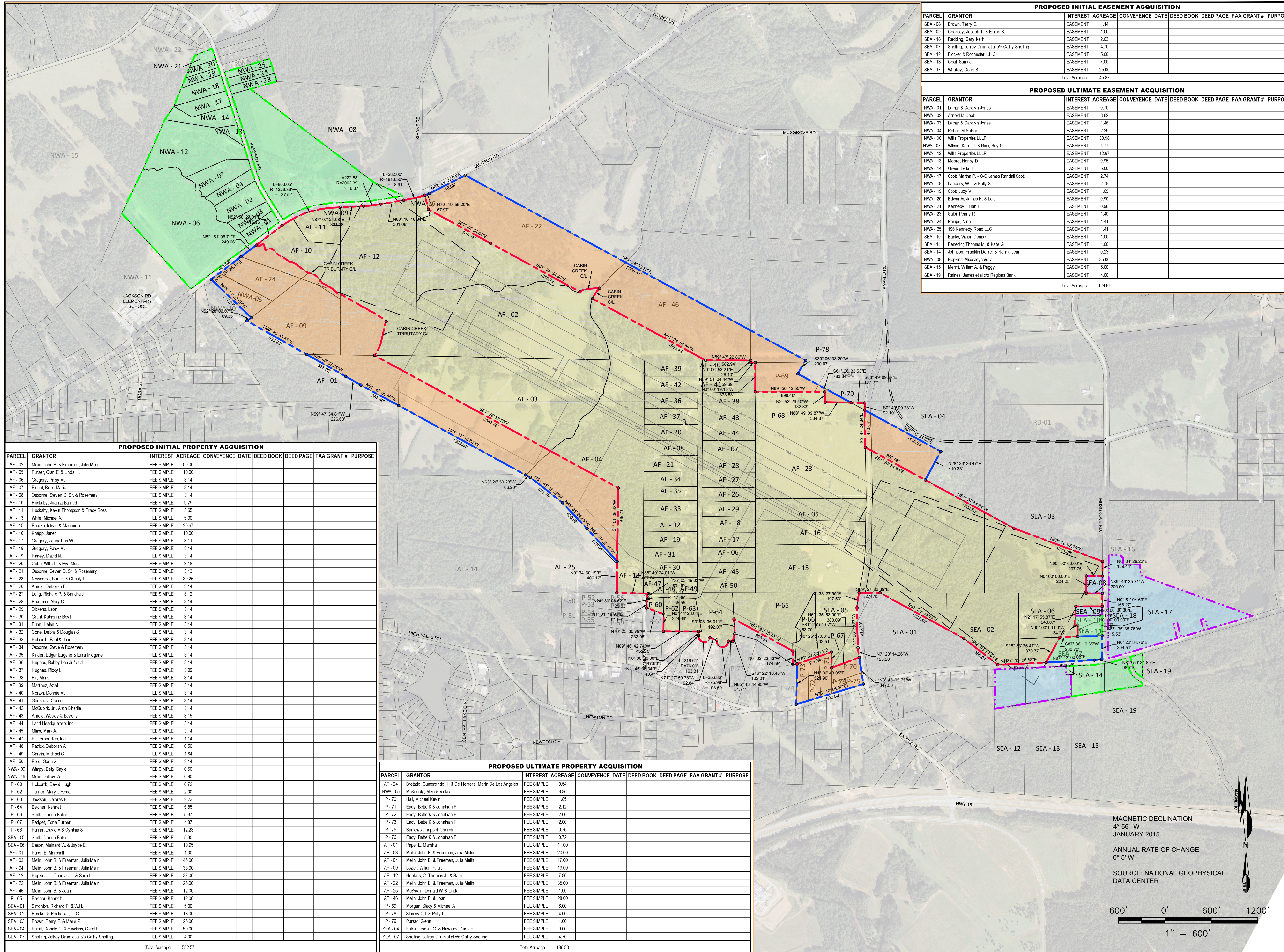

PROPOSED INITIAL PROPERTY ACQUISITION									
PARCEL	GRANTOR	INTEREST	ACREAGE	CONVEYANCE	DATE	DEED BOOK	DEED PAGE	FAA GRANT #	PURPOSE
AF-02	Mein, John B. & Freeman, Julia Mein	FEE SIMPLE	50.00						
AF-05	Purser, Olan E. & Linda H.	FEE SIMPLE	10.00						
AF-06	Gregory, Patsy M.	FEE SIMPLE	3.14						
AF-07	Blount, Rose Marie	FEE SIMPLE	3.14						
AF-08	Osborne, Steven D. Sr. & Rosemary	FEE SIMPLE	3.14						
AF-10	Huckabay, Juanita Bernard	FEE SIMPLE	9.79						
AF-11	Huckabay, Kevin Thompson & Tracy Ross	FEE SIMPLE	3.85						
AF-13	White, Michael A.	FEE SIMPLE	5.00						
AF-15	Bucko, Ivan & Marianne	FEE SIMPLE	20.67						
AF-16	Knapp, Janet	FEE SIMPLE	10.00						
AF-17	Gregory, Johnathan W.	FEE SIMPLE	3.11						
AF-18	Gregory, Patsy M.	FEE SIMPLE	3.14						
AF-19	Haney, David N.	FEE SIMPLE	3.14						
AF-20	Cobb, Wille L. & Eva Mae	FEE SIMPLE	3.18						
AF-21	Osborne, Steven D. Sr. & Rosemary	FEE SIMPLE	3.13						
AF-23	Newsome, Burt E. & Christy L.	FEE SIMPLE	30.26						
AF-26	Arnold, Deborah F.	FEE SIMPLE	3.14						
AF-27	Long, Richard P. & Sandra J.	FEE SIMPLE	3.12						
AF-28	Freeman, Mary C.	FEE SIMPLE	3.14						
AF-29	Dickens, Leon	FEE SIMPLE	3.14						
AF-30	Grant, Katherine Bevil	FEE SIMPLE	3.14						
AF-31	Burn, Helen N.	FEE SIMPLE	3.14						
AF-32	Cone, Debra & Douglas S.	FEE SIMPLE	3.14						
AF-33	Holcomb, Paul & Janet	FEE SIMPLE	3.14						
AF-34	Osborne, Steve & Rosemary	FEE SIMPLE	3.14						
AF-35	Kinder, Edgar Eugene & Eura Imogene	FEE SIMPLE	3.14						
AF-36	Hughes, Bobby Lee Jr / et al	FEE SIMPLE	3.14						
AF-37	Hughes, Ricky L.	FEE SIMPLE	3.09						
AF-38	Hill, Mark	FEE SIMPLE	3.14						
AF-39	Marinez, Abel	FEE SIMPLE	3.14						
AF-40	Norton, Donnie M.	FEE SIMPLE	3.14						
AF-41	Gonzalez, Cecilio	FEE SIMPLE	3.14						
AF-42	McGuirk, Jr., Alton Charlie	FEE SIMPLE	3.14						
AF-43	Arnold, Wesley & Beverly	FEE SIMPLE	3.15						
AF-44	Land Headquarters Inc.	FEE SIMPLE	3.14						
AF-45	Mims, Mark A.	FEE SIMPLE	3.14						
AF-47	PTI Properties, Inc.	FEE SIMPLE	1.14						
AF-48	Patric, Deborah A.	FEE SIMPLE	0.50						
AF-49	Cavan, Michael C.	FEE SIMPLE	1.64						
AF-50	Ford, Gena S.	FEE SIMPLE	3.14						
NWA-09	Wemy, Betty Gayle	FEE SIMPLE	0.50						
NWA-16	Mein, Jeffrey W.	FEE SIMPLE	0.90						
P-60	Holcomb, David Hugh	FEE SIMPLE	0.72						
P-62	Turner, Mary L Reed	FEE SIMPLE	2.00						
P-63	Jackson, Delores E	FEE SIMPLE	2.23						
P-64	Belcher, Kenneth	FEE SIMPLE	5.85						
P-66	Smith, Donna Butler	FEE SIMPLE	5.37						
P-67	Padgett, Edna Turner	FEE SIMPLE	4.87						
P-68	Farrar, David A & Cynthia S	FEE SIMPLE	12.23						
SEA-05	Smith, Donna Butler	FEE SIMPLE	5.30						
SEA-06	Eason, Mainard W. & Joyce E.	FEE SIMPLE	10.95						
AF-01	Pape, E. Marshall	FEE SIMPLE	1.00						
AF-03	Mein, John B. & Freeman, Julia Mein	FEE SIMPLE	45.00						
AF-04	Mein, John B. & Freeman, Julia Mein	FEE SIMPLE	33.00						
AF-12	Hopkins, O. Thomas Jr. & Sara L.	FEE SIMPLE	37.00						
AF-22	Mein, John B. & Freeman, Julia Mein	FEE SIMPLE	25.00						
AF-46	Mein, John B. & Joan	FEE SIMPLE	12.00						
P-65	Belcher, Kenneth	FEE SIMPLE	12.00						
SEA-01	Smonton, Richard F. & W.H.	FEE SIMPLE	5.00						
SEA-02	Blocker & Rochester, LLC	FEE SIMPLE	18.00						
SEA-03	Brown, Terry E. & Marie P.	FEE SIMPLE	25.00						
SEA-04	Futal, Donald G. & Hawkins, Carol F.	FEE SIMPLE	50.00						
SEA-07	Snelling, Jeffrey Drum et al c/o Cathy Snelling	FEE SIMPLE	4.00						
			<b>Total Acreage</b>	<b>552.57</b>					

PROPOSED ULTIMATE PROPERTY ACQUISITION									
PARCEL	GRANTOR	INTEREST	ACREAGE	CONVEYANCE	DATE	DEED BOOK	DEED PAGE	FAA GRANT #	PURPOSE
AF-24	Bretado, Omerando H. & De Herrera, Maria De Los Angeles	FEE SIMPLE	9.54						
NWA-05	McKneely, Mike & Vickie	FEE SIMPLE	3.86						
P-70	Hall, Michael Kevin	FEE SIMPLE	1.85						
P-71	Eady, Bebe K & Jonathan F	FEE SIMPLE	2.12						
P-72	Eady, Bebe K & Jonathan F	FEE SIMPLE	2.00						
P-73	Eady, Bebe K & Jonathan F	FEE SIMPLE	2.00						
P-75	Barrows Chappell Church	FEE SIMPLE	0.75						
P-76	Eady, Bebe K & Jonathan F	FEE SIMPLE	0.72						
AF-01	Pape, E. Marshall	FEE SIMPLE	11.00						
AF-03	Mein, John B. & Freeman, Julia Mein	FEE SIMPLE	20.00						
AF-04	Mein, John B. & Freeman, Julia Mein	FEE SIMPLE	17.00						
AF-09	Loose, William F. Jr.	FEE SIMPLE	19.00						
AF-12	Hopkins, O. Thomas Jr. & Sara L.	FEE SIMPLE	7.96						
AF-22	Mein, John B. & Freeman, Julia Mein	FEE SIMPLE	35.00						
AF-25	McSwain, Donald W. & Linda	FEE SIMPLE	1.00						
AF-46	Mein, John B. & Joan	FEE SIMPLE	28.00						
P-69	Morgan, Stacy & Michael A	FEE SIMPLE	6.00						
P-78	Stamey C.L. & Patsy L.	FEE SIMPLE	4.00						
P-79	Purser, Glenn	FEE SIMPLE	1.00						
SEA-04	Futal, Donald G. & Hawkins, Carol F.	FEE SIMPLE	9.00						
SEA-07	Snelling, Jeffrey Drum et al c/o Cathy Snelling	FEE SIMPLE	4.70						
			<b>Total Acreage</b>	<b>186.50</b>					

MAGNETIC DECLINATION  
4° 58' W  
JANUARY 2015  
  
ANNUAL RATE OF CHANGE  
0° 5' W  
  
SOURCE: NATIONAL GEOPHYSICAL  
DATA CENTER

600' 0' 600' 1200'  
1" = 600'